

BODY

INSTRUMENT PANEL	14- 2	INSTALLING REAR GLASS	
STRUCTURAL VIEW	14- 2	HATCH	14-12
SEATS	14- 3	ADJUSTING REAR GLASS HATCH	
STRUCTURAL VIEW	14- 3	LOCK	14-12
INSPECTION	14- 3	ADJUSTING REAR GLASS HATCH	
SEAT BELTS	14- 4	HINGES	14-12
STRUCTURAL VIEW	14- 4	TOP CEILING (FULL ROOF)	14-13
SEAT BELT AND RETRACTOR		REMOVING TOP CEILING	14-13
ASSEMBLY	14- 5	INSTALLING TOP CEILING	14-13
HOOD	14- 5	TOP CEILING (SUNROOF TYPE)	14-14
REMOVING HOOD	14- 5	REMOVING TOP CEILING	14-14
INSTALLING HOOD	14- 5	INSTALLING TOP CEILING	14-14
ADJUSTING HOOD	14- 5	RETRACTABLE HEADLIGHTS	14-15
ADJUSTING LOCK	14- 5	STRUCTURAL VIEW	14-15
FRONT BUMPER	14- 5	REPLACING RETRACTABLE HEAD-	
REMOVING FRONT BUMPER	14- 5	LIGHT	14-16
INSPECTING SHOCK		ADJUSTING HEADLIGHT AIM	14-16
ABSORBER	14- 6	REPLACING RETRACTOR	
INSTALLING FRONT BUMPER	14- 6	HINGE	14-17
REAR BUMPER	14- 6	REPLACING RETRACTOR MOTOR	
REMOVING REAR BUMPER	14- 6	AND LINKAGE ASSEMBLY	14-17
INSPECTING SHOCK		ADJUSTING HEADLIGHT LID	14-18
ABSORBER	14- 7	WINDSHIELD WIPER MOTOR	14-19
INSTALLING REAR BUMPER	14- 7	REMOVING WIPER MOTOR	14-19
DOORS	14- 8	INSTALLING WIPER MOTOR	14-19
STRUCTURAL VIEW	14- 8	WINDSHIELD GLASS	14-20
ADJUSTING DOOR LOCK		REMOVING WINDSHIELD	
STRIKER	14- 9	GLASS	14-20
REMOVING DOOR GLASS AND		INSTALLING WINDSHIELD	
REGULATOR	14- 9	GLASS	14-20
INSTALLING DOOR GLASS AND		SIDE WINDOW GLASS	14-22
REGULATOR	14- 9	REMOVING SIDE WINDOW	
ADJUSTING DOOR GLASS		GLASS	14-22
REGULATOR	14-10	INSTALLING SIDE WINDOW	
REMOVING DOOR LOCK	14-10	GLASS	14-22
INSTALLING DOOR LOCK	14-11	BODY CHECKING DIMENSIONS	14-24
REAR GLASS HATCH	14-11		
REMOVING REAR GLASS			
HATCH	14-11		

14 INSTRUMENT PANEL

INSTRUMENT PANEL

STRUCTURAL VIEW

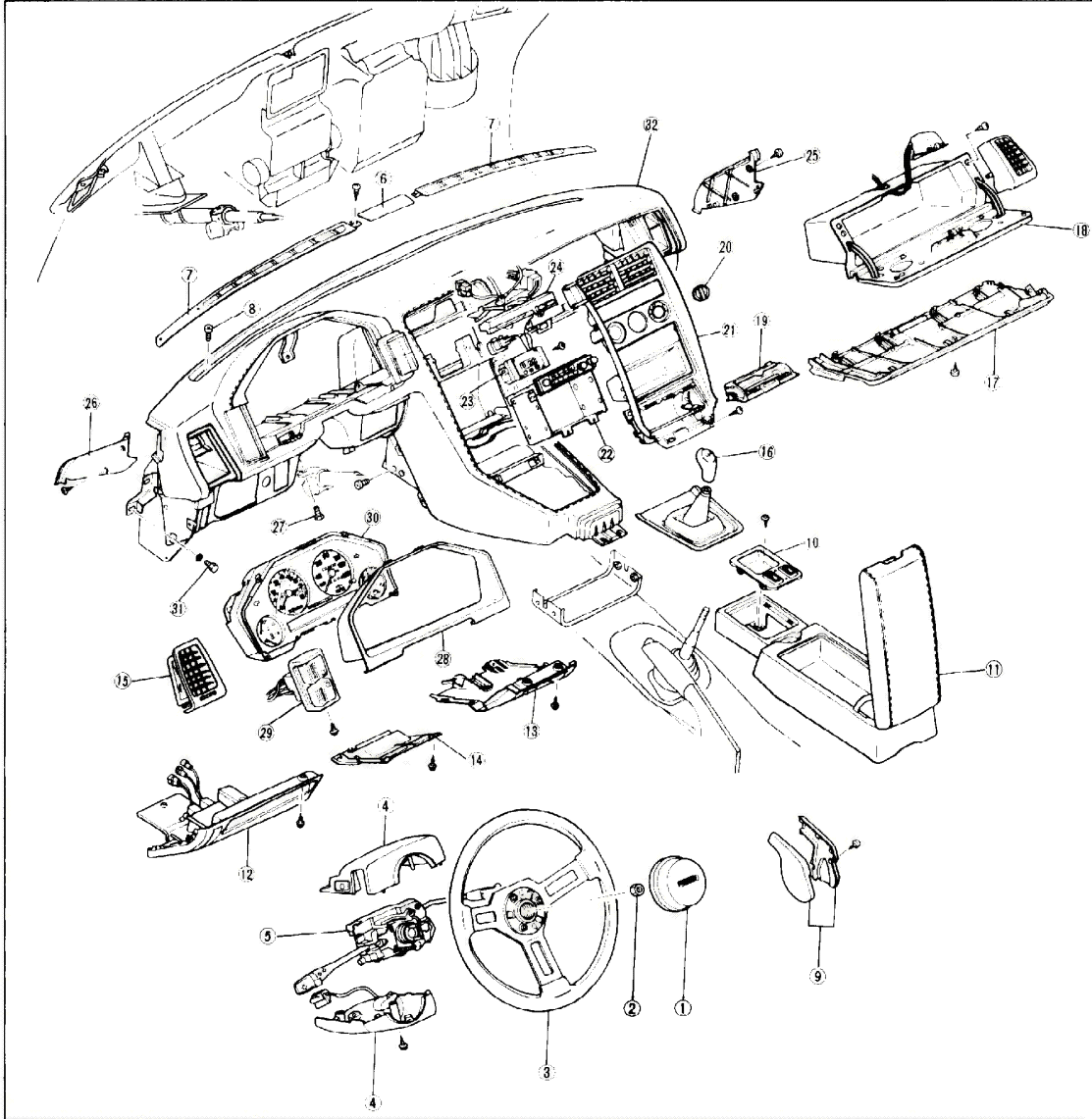

47U14X-003

- | | | |
|---------------------------------|----------------------|---------------------|
| 1 Horncap | 12 Switch panel | 23 Clock |
| 2 Nut | 13 Switch panel | 24 Heater wire |
| 3 Steering wheel | 14 Panel | 25 Garnish |
| 4 Column covers (upper & lower) | 15 Ventilator louver | 26 Garnish |
| 5 Combination switch | 16 Shift lever knob | 27 Bolts(2) |
| 6 Grille | 17 Glove poket lid | 28 Meter hood |
| 7 Grille | 18 Glove compartment | 29 Cluster switch |
| 8 Bolts(3) | 19 Ash tray | 30 Meter |
| 9 Brake cover | 20 Knobe | 31 Bolts(4) |
| 10 Coin box | 21 Center panel | 32 Instrument panel |
| 11 Rear console | 22 Radio & Cover | |

SEATS

STRUCTURAL VIEW

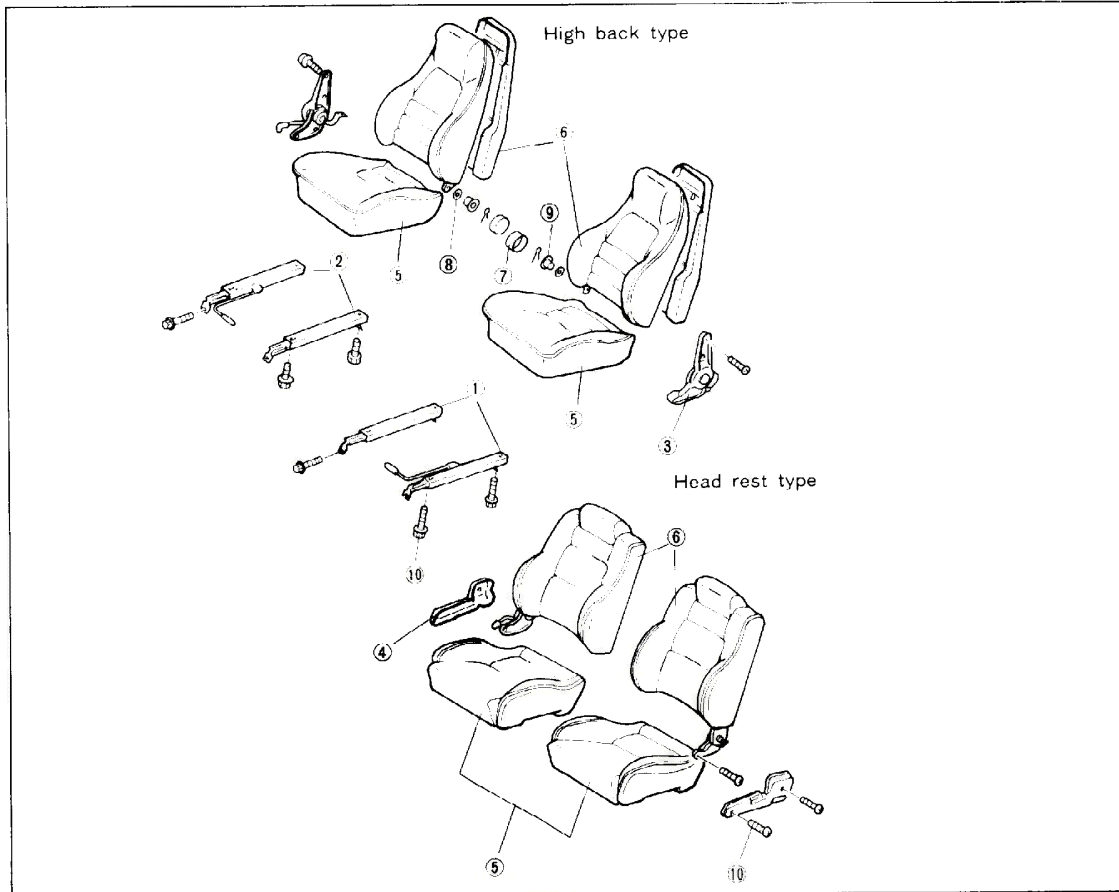

47U14X-004

- 1 Adjuster
- 2 Adjuster
- 3 Reclining knuckle
- 4 Knuckle cover
- 5 Seat cushion

- 6 Seat back
- 7 Hinge cover
- 8 Washer
- 9 Bush
- 10 Bolt

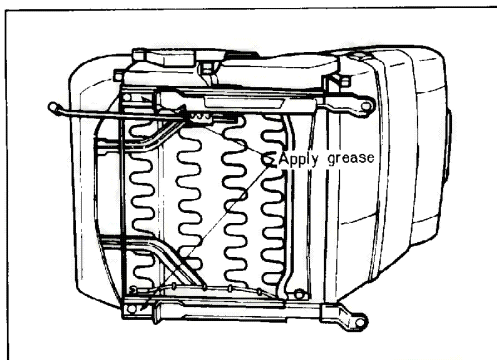

47U14X-005

INSPECTION

- a) Check to be sure that the seat adjuster lever and reclining knuckle move smoothly.
Apply grease to the moving parts.
- b) Check the adjustment lever for wear.
- c) Check the front seat mounting bolts for looseness.

SEAT BELTS

STRUCTURAL VIEW

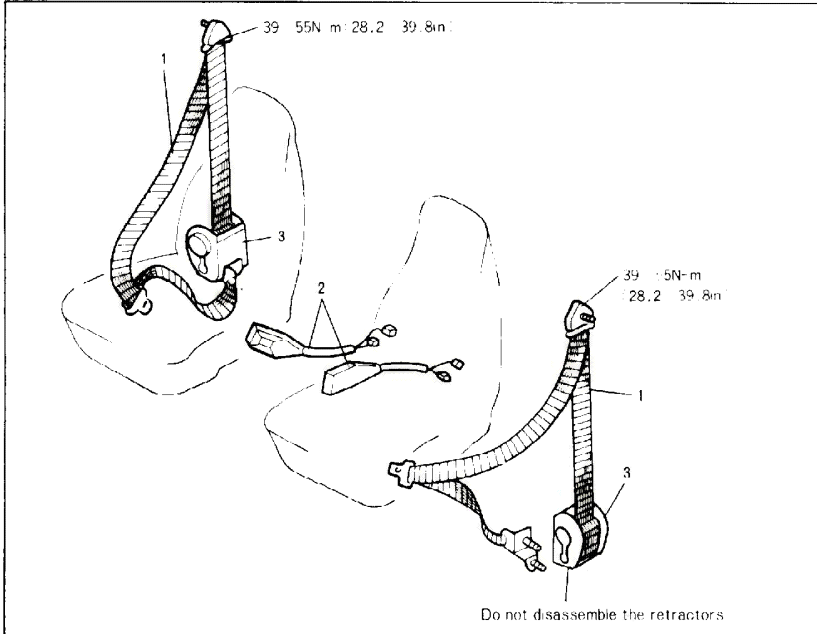

- 1 Seat belt
- 2 Buckles
- 3 Retractors

47U14X-006

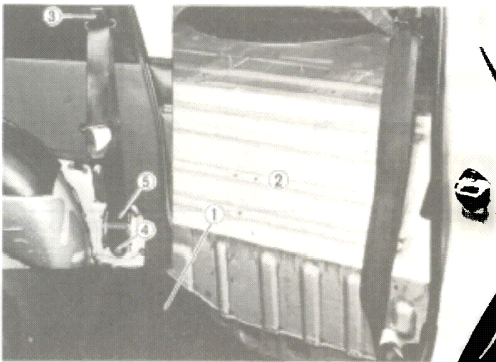

47U14X-007

SEAT BELT AND RETRACTOR ASSEMBLY

To replace the seat belt and retractor assembly proceed as follows.

1. Remove the rear floor mat.
2. Remove the floor plate.
3. Remove the seat belt anchor bolt.
4. Remove the bolt attaching the seat belt retractor.
5. Remove the seat belt and retractor assembly.

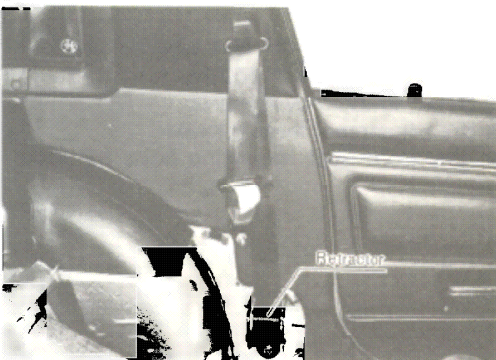

47U14X-008

6. Install the seat belt and retractor assembly in the reverse order of removing.

Caution

Tighten the retractor attaching bolt so that the retractor positioned vertically.

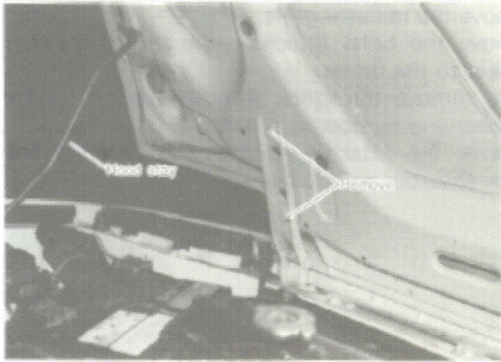

47U14X-009

HOOD

REMOVING HOOD

1. Open the hood and mark the hood hinge locations on the hood.
2. Remove the hood stay.
3. With an assistant supporting one side of the hood remove the hood mounting bolts.
4. Lift the hood off the vehicle.

INSTALLING HOOD

Follow the removal procedures in the reverse order.

ADJUSTING HOOD

Make the to-and-fro, side-to-side and up-and-down adjustments by loosening the hood mounting bolts.

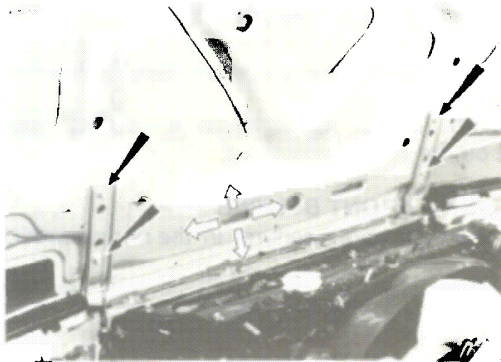

47U14X-010

ADJUSTING HOOD LOCK

To adjust the hood lock, loosen the hood lock attaching bolts and move the lock as required to align with the striker.

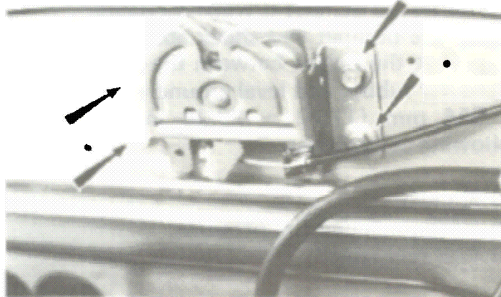

47U14X-011

FRONT BUMPER

REMOVING FRONT BUMPER

1. Remove the battery.
2. Disconnect the wire connectors from the front turn signal lights.
3. Remove the nuts attaching the piston rod end of the shock absorber to the body.
Raise the front end of the vehicle and support it with stands.

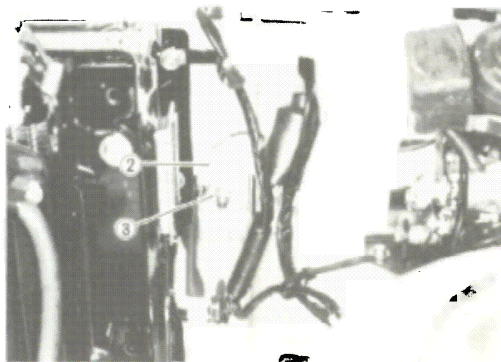

47U14X-012

14 FRONT BUMPER, REAR BUMPER

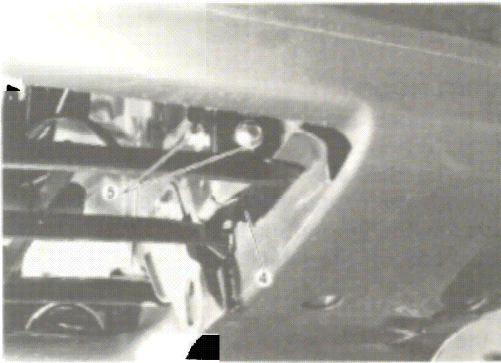

47U14X-013

4. Remove the radiator grille.
5. Remove the bolts attaching the shock absorber bracket to the frame.
Then, remove the shock absorber bracket, shock absorber and bumper assembly.
6. Remove the attaching bolts, and separate the shock absorber and bumper.

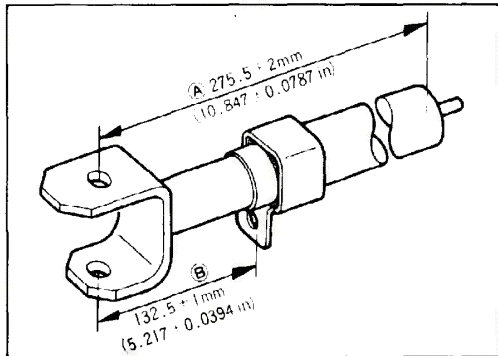

47U14X-014

INSPECTING SHOCK ABSORBER

Measure the length (A) if the length is not within the specification, replace the shock absorber with a new one.

The length (B) can be adjusted by moving the bracket on the shock absorber.

INSTALLING FRONT BUMPER

Follow the removal procedures in the reverse order.

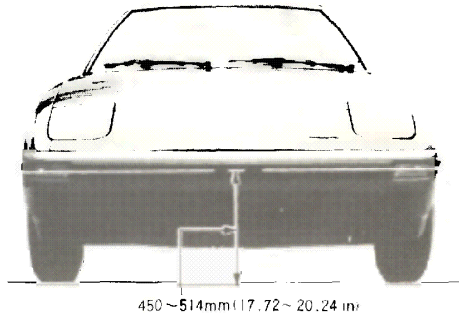

450 ~ 514mm (17.72 ~ 20.24 in)

47U14X-015

Cautions

- a) The bumper face is made of Urethane be careful not to damage it when servicing.
- b) Install the bumper and shock absorber assembly so that the height between the center of the protector rubber and level ground is within 450 ~ 514 mm (17.72 ~ 20.24 in) under the following conditions.

- (1) No load
- (2) Recommended tire pressure
- (3) Full fuel tank



47U14X-016

REAR BUMPER

REMOVING REAR BUMPER

1. Open the rear glass hatch and remove the service hole cover.
2. Remove the nuts attaching the piston rod end of the shock absorber to the frame.
3. Raise the rear end of the vehicle and support it with stands.

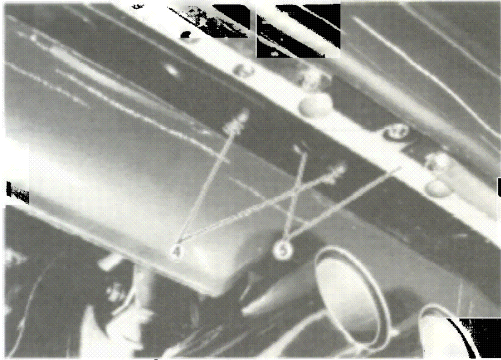

47U14X-017

4. Remove the nuts attaching the shock absorber bracket to the frame.
5. Remove the shock absorber bracket, shock absorber and rear bumper assembly.
6. Remove the attaching bolts, and separate the shock absorber and bumper.

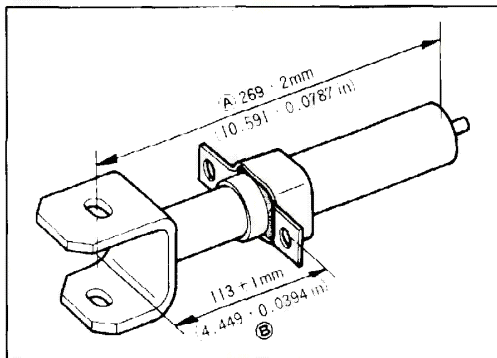

47U14X-018

INSPECTING SHOCK ABSORBER

Measure the length (A) and if the length is not within the specification, replace the shock absorber with a new one.

The length (B) can be adjusted by moving the bracket on the shock absorber.

INSTALLING REAR BUMPER

Follow the removal procedures in the reverse order.

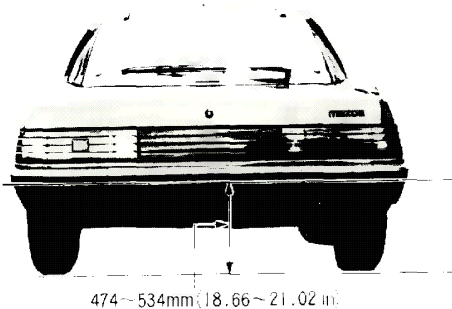

474 ~ 534mm (18.66 ~ 21.02 in.)

47U14X-019

Cautions

- a) The bumper face is made of Urethane and be careful not to damage it when servicing.
- b) Install the bumper and shock absorber assembly so that the height between the center of the protector rubber and level ground is within 474 ~ 534 mm (18.66 ~ 21.02 in) under the following conditions.

- (1) No load
- (2) Recommended tire pressure
- (3) Full fuel tank

DOORS

STRUCTURAL VIEW

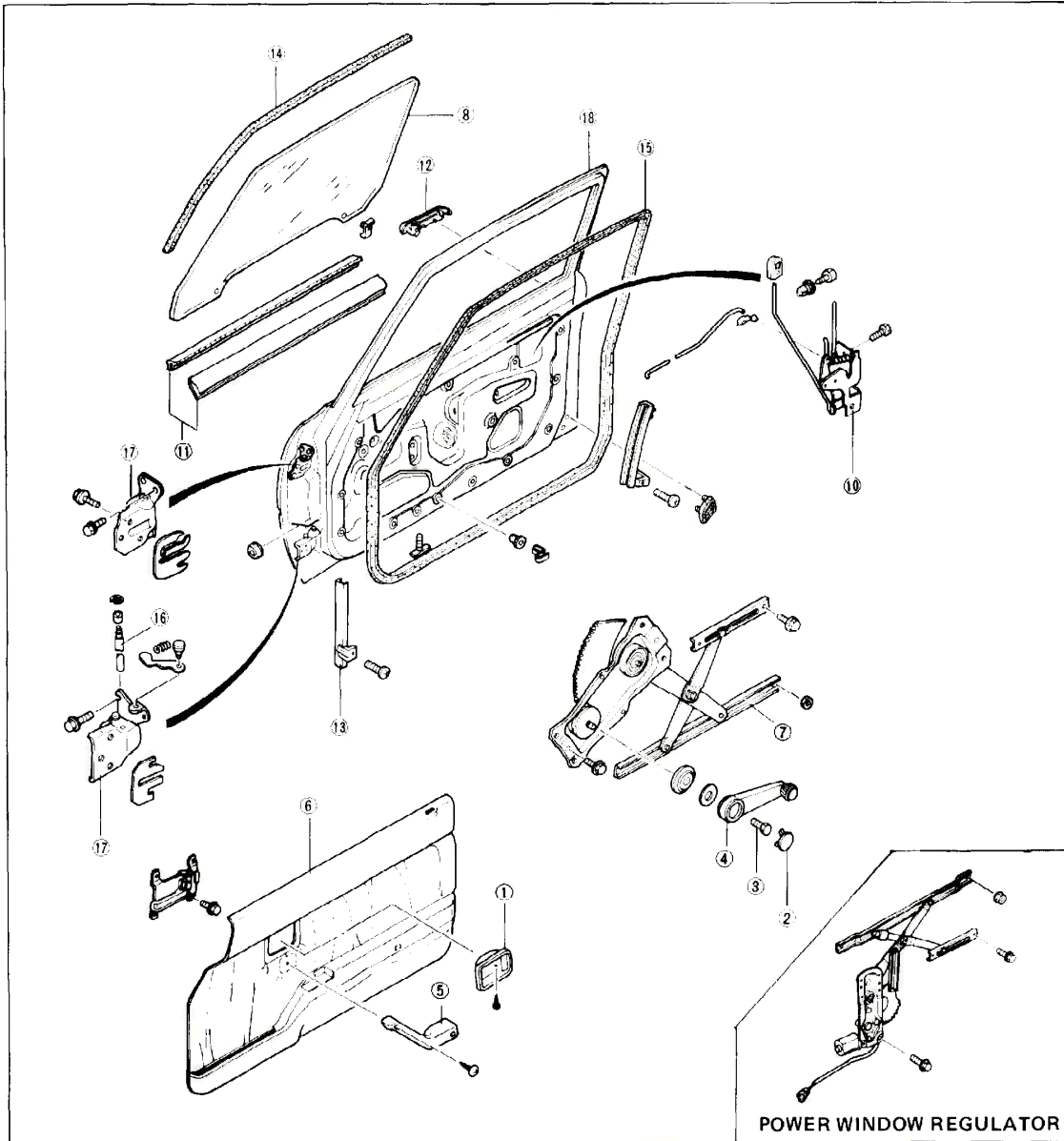

POWER WINDOW REGULATOR

47U14X-020

- | | |
|------------------------|-----------------------------------|
| 1 Inner handle cover | 10 Door lock |
| 2 Regulator handle cap | 11 Weatherstrip (outer and inner) |
| 3 Bolt | 12 Outer handle |
| 4 Regulator handle | 13 Glass guide |
| 5 Arm rest | 14 Glass channel |
| 6 Door trim | 15 Weatherstrip |
| 7 Regulator | 16 Checker pin |
| 8 Glass | 17 Door checker |
| 9 Belt-line molding | 18 Door |

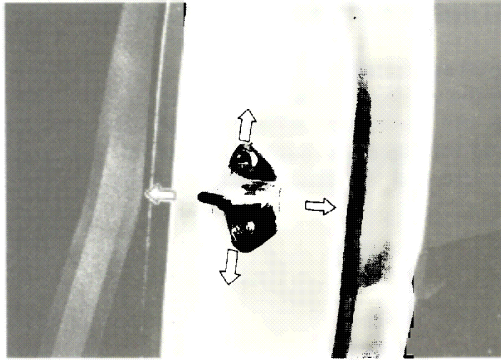

47U14X-021

ADJUSTING DOOR LOCK STRIKER

The striker can be adjusted in-and-out and up-and-down.

1. Loosen the striker attaching screws and move the striker as required.
2. Tighten the attaching screws and check the door fit.

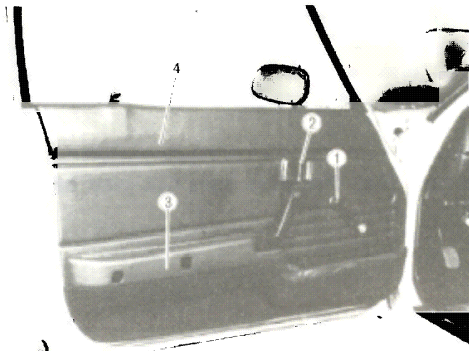

47U14X-022

REMOVING DOOR GLASS AND REGULATOR

1. Remove the regulator handle.
2. Remove the inner handle cover.
3. Remove the arm rest.
4. Remove the trim panel.
5. Remove the inner handle assembly.
6. Remove the watershield.

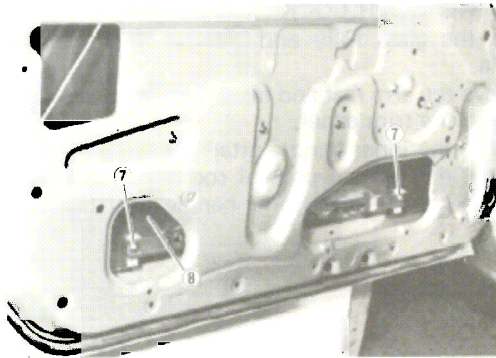

47U14X-023

7. Remove the screws attaching the glass and regulator. Then remove the screw grommets.
8. Remove the glass.

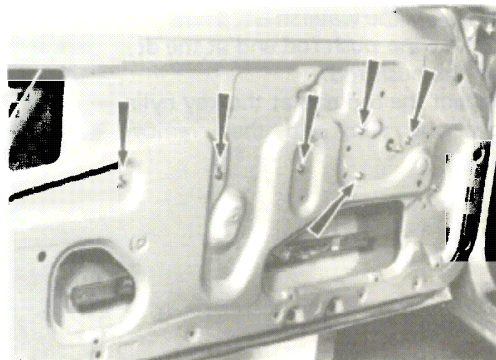

57U14X-024

9. Remove the regulator attaching bolts, and take out the regulator assembly through the service hole.
10. Remove the window motor mounting bolts, then remove the motor from regulator. (Power window Type)

WARNING

Use extreme care when removing motor; it will release the spring and let regulator gear snap back to "UP" position (Power window Type).

INSTALLING DOOR GLASS AND REGULATOR

Follow the removal procedures in the reverse order. Adjust the regulator if necessary.

(Power window Type)

Before installing the motor, connect the leads to a battery and run regulator "DOWN" to position shown.

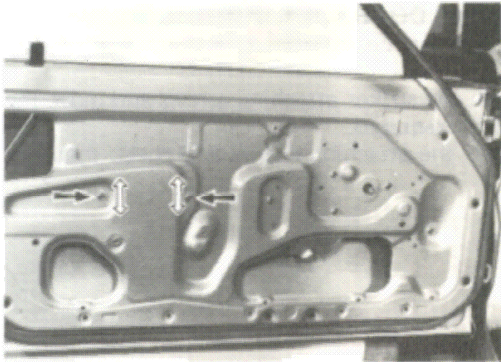

47U14X-025

ADJUSTING DOOR GLASS REGULATOR

Horizontal adjustment

1. Raise the window to full up position.
2. Make the horizontal adjustment of the glass by moving the regulator guide up or down.
3. Make sure that the glass moves smoothly.

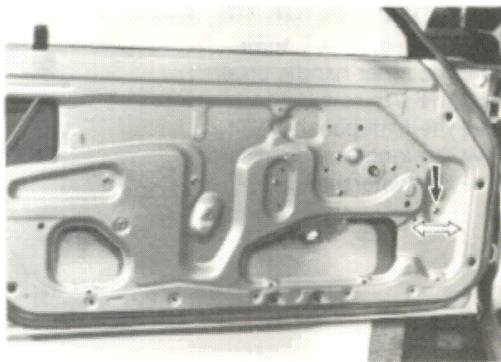

47U14X-026

Fore and aft adjustment

1. Loosen the adjusting bolt and move the glass guide as required.
2. Tighten the adjusting bolt.

Caution

Make sure that the glass does not play back and forth.

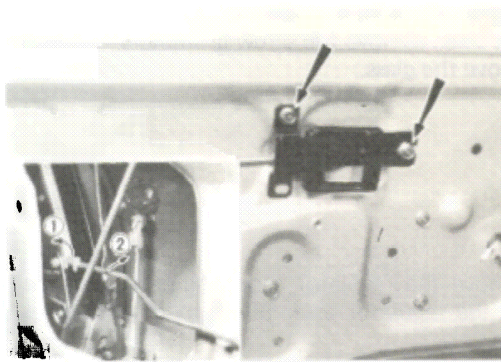

47U14X-027

REMOVING DOOR LOCK

1. Raise the glass fully and remove the regulator handle.
2. Remove the arm rest and inner handle cover.
3. Remove the trim panel.
4. Remove the inner handle attaching bolts and disconnect the remote control rod end at the door lock. Then remove the inner handle assembly.

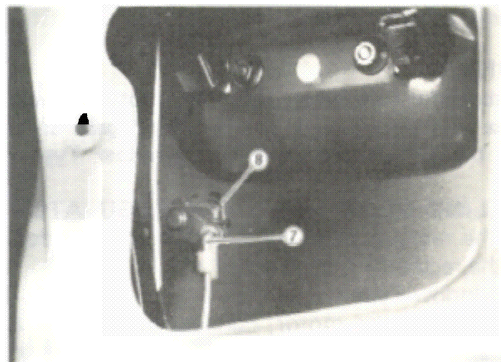

47U14X-028

5. Carefully pry the watershield away.
6. Disconnect the push rod end at the door lock and remove the push rod.
7. Disconnect the rod end at the key cylinder.
8. Remove the clip, and then remove the key cylinder.

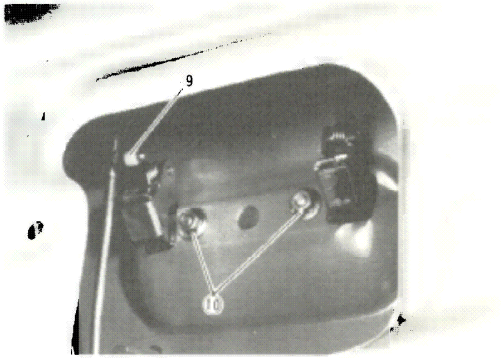

47U14X-029

9. Disconnect the rod end at the outer handle.
10. Remove the outer handle attaching nuts, and then remove the outer handle.

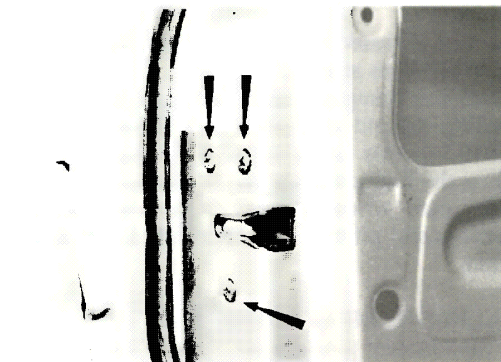

47U14X-030

11. Remove the door lock attaching screws and take out the door lock through the service hole.

INSTALLING DOOR LOCK

Follow the removal procedures in the reverse order, **noting** the following points.

1. Before installing the door lock assembly, the outer handle nylon bush should be exchanged for a new one.
2. The inner handle should be adjusted to proper play.

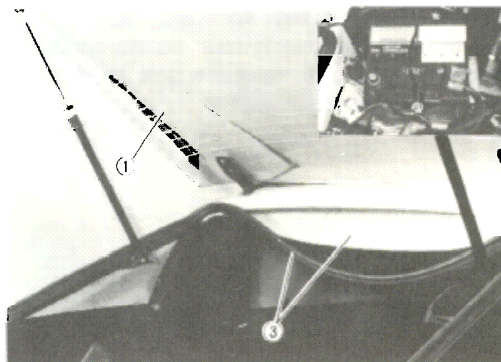

47U14X-031

REAR GLASS HATCH

REMOVING REAR GLASS HATCH

1. Open the rear glass hatch.
2. Disconnect the battery negative cable.
3. Remove the weatherstrip and top ceiling at the rear end of the roof.

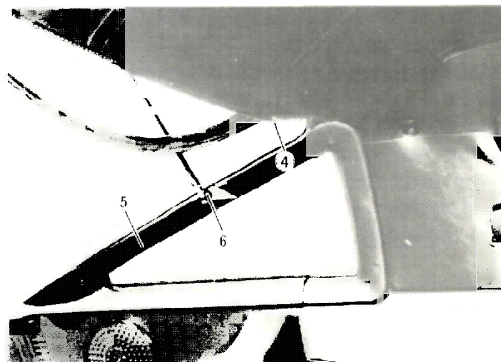

47U14X-032

4. Disconnect the electrical connector for the rear defroster from the rear pillar.
5. Remove the rear side pillar trim.
6. Disconnect the damper stay at the body.
7. Close the rear glass hatch.

Caution

Be careful not to damage the filament on the rear glass hatch during the servicing.

14 REAR GLASS HATCH



47U14X-033

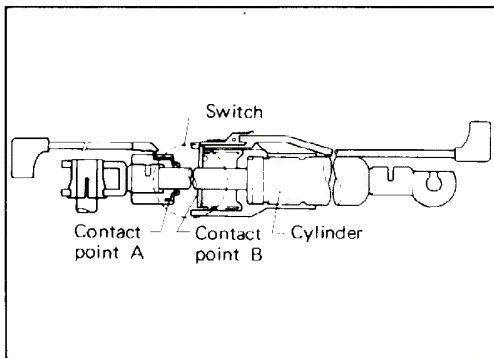

47U14X-034

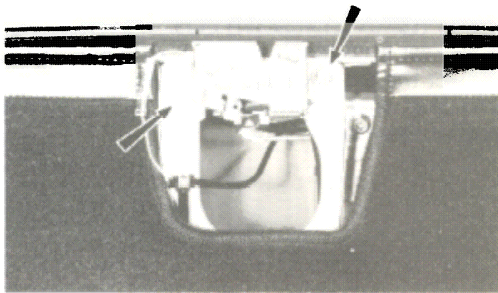

47U14X-035

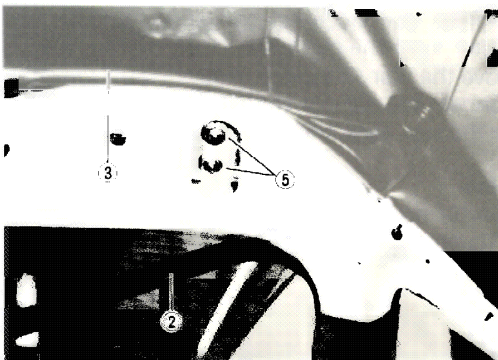

47U14X-036

8. Remove the attaching nuts for the glass hatch hinges.
9. Release the glass hatch lock and remove the glass hatch with the hinge attached.
10. If necessary, remove the damper stays, hinges and glass hatch lock striker from the glass.

Cautions

- a) Do not disassemble the damper stay as it is filled with gas and oil.
- b) When the damper stay is replaced, before discarding the old one, drill a 2 or 3 mm (0.079 ~ 0.118 in) hole at the lower end of cylinder and allow the high pressure gas to escape. Take care when venting it out as the drill cuttings and oil might fly out with considerable force.

INSTALLING REAR GLASS HATCH

Follow the removal procedures in the reverse order.

ADJUSTING REAR GLASS HATCH LOCK

To adjust the rear glass hatch lock, loosen the hatch lock attaching bolts and move the lock as required to align the rear glass hatch striker.

ADJUSTING REAR GLASS HATCH HINGES

1. Open the rear glass hatch.
2. Remove the upper part of the weatherstrip.
3. Remove the rear end of the top ceiling.
4. Remove the rear header pads.
5. Close the rear glass hatch and loosen the hinge attaching nuts and move the rear glass hatch as required to align with the body.
6. Tighten the hinge attaching nuts.

TOP CEILING (FULL ROOF)

REMOVING TOP CEILING

1. Remove the rear view mirror.
2. Remove the sun visors.
3. Remove the seaming welts.
4. Remove the front pillar trims.

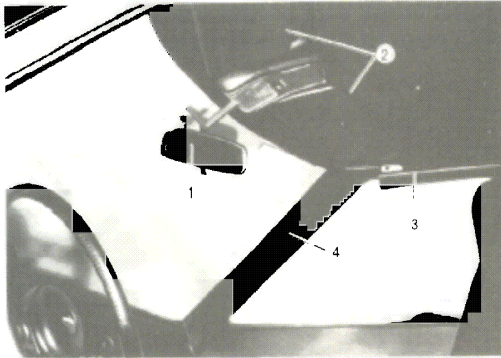

47U14X-037

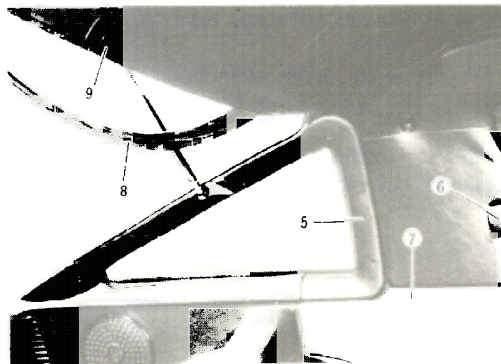

47U14X-038

5. Remove the rear center trims.
6. Remove the seat belt anchor bolts.
7. Remove the rear quarter trim panels.
8. Remove the upper part of the weatherstrip.
9. Remove the listing wires and top ceiling.
10. Remove the rear header pads.

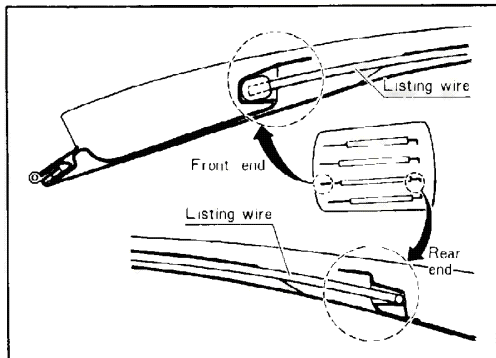

47U14X-039

INSTALLING TOP CEILING

Follow the removal procedures in the reverse order, **noting** the following points.

1. Heat up the top ceiling to a temperature of **30°C to 50°C (86°F to 122°F)**.
2. Insert both ends of the listing wires to their respective position in successive order beginning from the center.

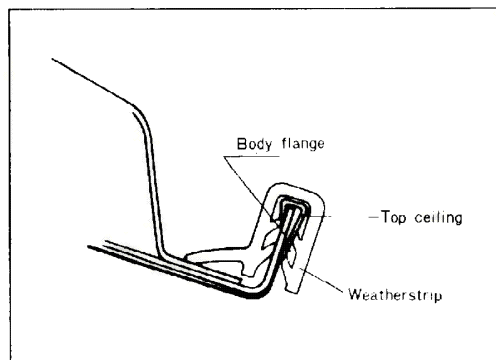

47U14X-040

3. Install the rear end of the top ceiling to the body flange as shown in figure.

14 TOP CEILING (SUNROOF TYPE)

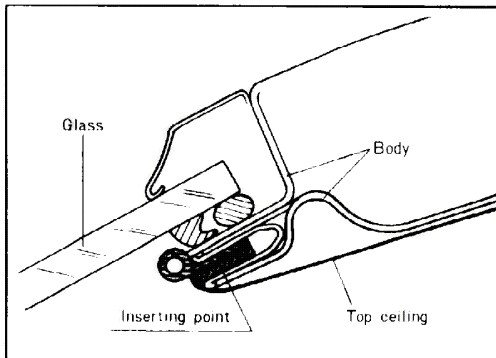

47U14X-041

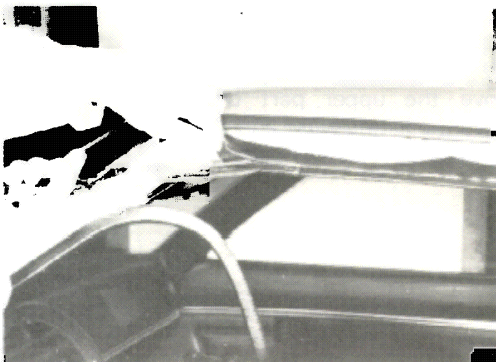

47U14X-042

4. Insert the front end of the top ceiling to the inserting point of the body as shown in figure.

5. Apply double-sided adhesive tape to the outside of the body flange.

6. Pull the top ceiling from both sides to avoid any slackening and glue both sides onto the body flange.

7. After the top ceiling is properly attached to the body flange, clip off the all protruding edges.

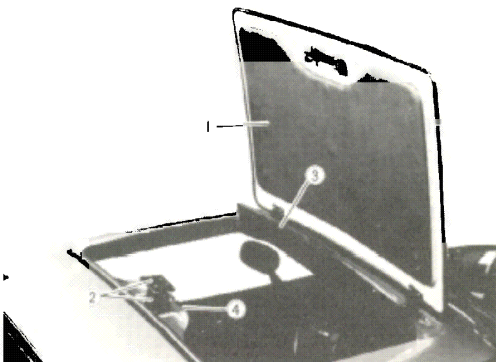

47U14X-043

TOP CEILING (SUNROOF TYPE)

REMOVING TOP CEILING

After remove the parts as described in Page 14–13 (Steps 1 to 8), remove the following parts.

1. Sunroof
2. Handwheel assembly
3. Deflector and hinges
4. Top ceiling

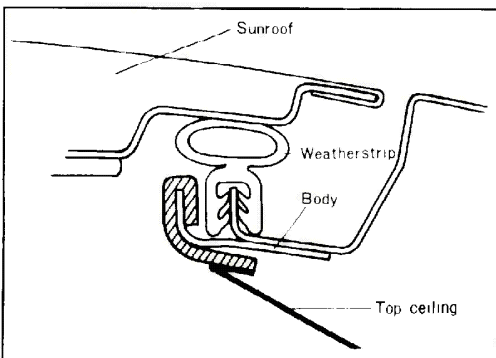

47U14X-044

INSTALLING TOP CEILING

Follow the removal procedudres in the reverse order, **noting** the following points.

1. Heat up the top ceiling to a temperature of **30°C to 50°C (86°F to 122°F)**.
2. Install the opening edge of the top ceiling to the body opening flange as shown in figure.
3. Install the front, rear and side ends of the top ceiling to the body, referring the Steps 3 to 7 on Page 14–13, 14.

RETRACTABLE HEADLIGHTS

STRUCTURAL VIEW

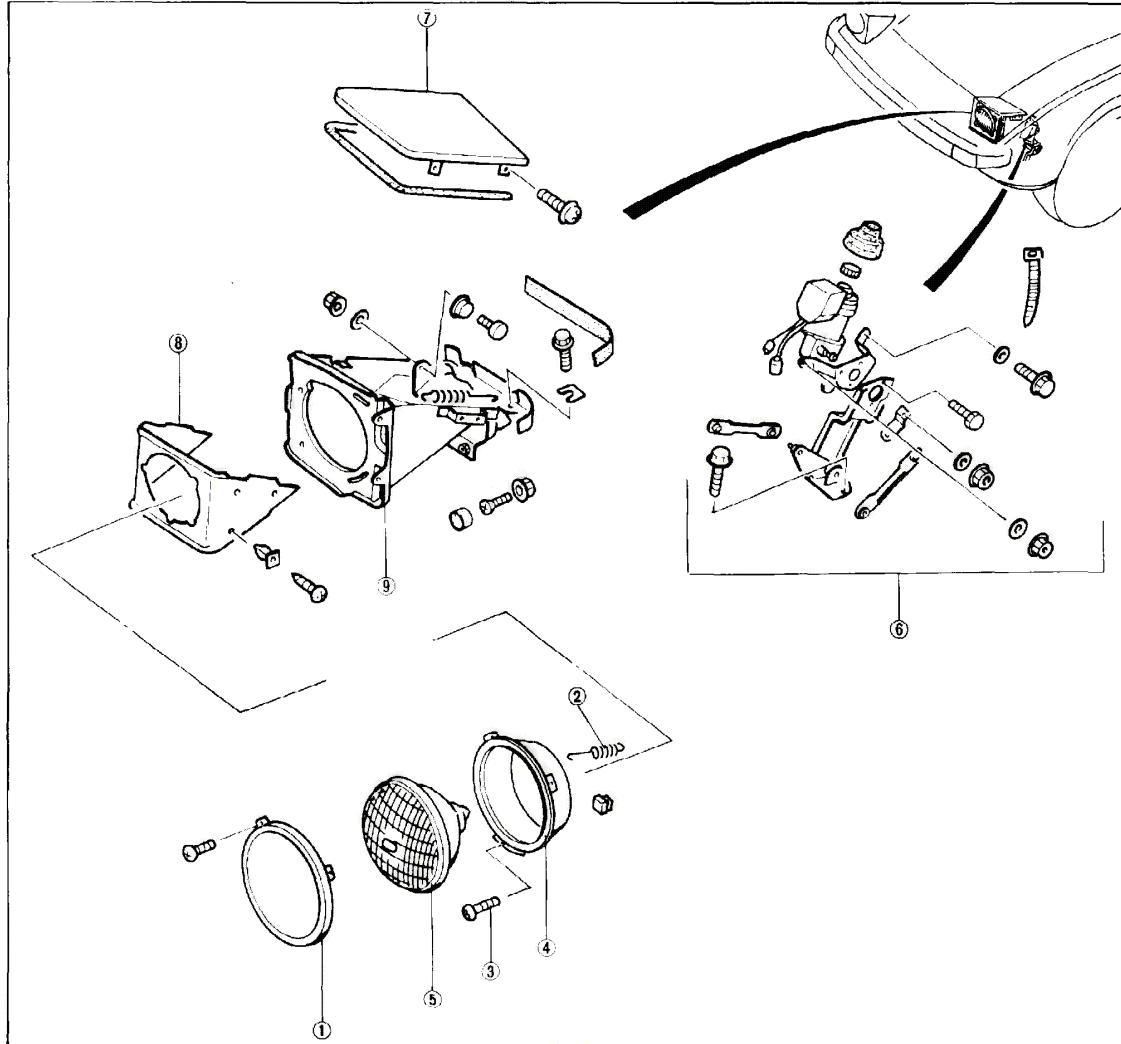

- | | |
|------------------|------------------|
| 1 Lamp bezel | 6 Motor & Link |
| 2 Adjust spring | 7 Lamp lid |
| 3 Adjust screw | 8 Protector |
| 4 Retaining ring | 9 Lamp lid hinge |
| 5 Sealed beam | |

47U14X-04b

14 RETRACTABLE HEADLIGHTS

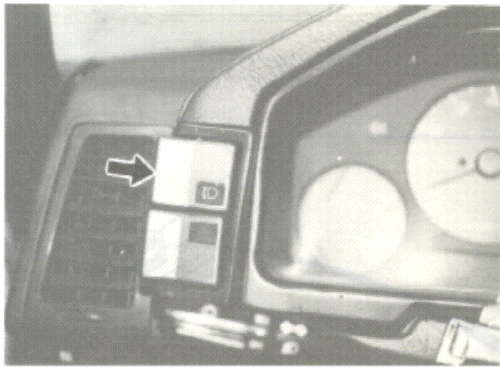

47U14X-046

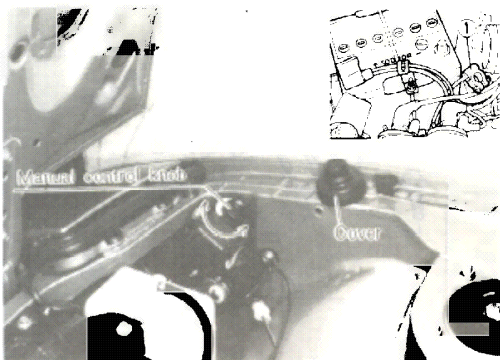

47U14X-047

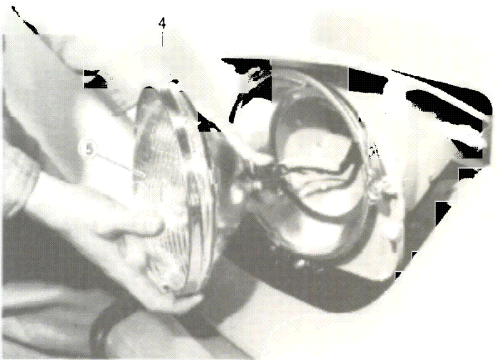

47U14X-048

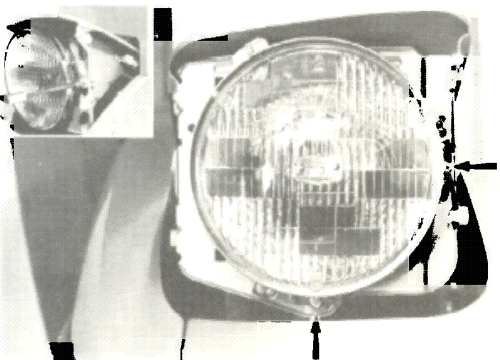

47U14X-049

REPLACING RETRACTABLE HEADLIGHTS

1. Turn on the headlight retractor switch to raise the headlight in position.

Cautions

Should the retractor fail to operate automatically after the retractor switch has been turned on, raise the headlight manually as follows;

- a) Disconnect the battery negative cable.
- b) Remove the cover and turn the manual control knob on the retractor motor shaft until the headlight is fully raised.

2. Disconnect the battery negative cable.
3. Remove the headlight bezel.
4. Loosen the headlight retaining ring attaching screws.
Rotate the retaining ring counterclockwise and remove it while holding the headlight.
5. Take out the headlight and disconnect the electrical connector. Remove the headlight.
6. Install a new headlight in the reverse order of removing.
7. Adjust the headlight arm.

ADJUSTING HEADLIGHTS AIM

Before adjusting the headlights, make sure that the tires are inflated uniformly to recommended pressure and the vehicle is on the level ground without load.

Adjust the headlights to meet the regulation of your country.

To adjust the headlights, turn the two adjusting screws until the headlight is properly aimed.

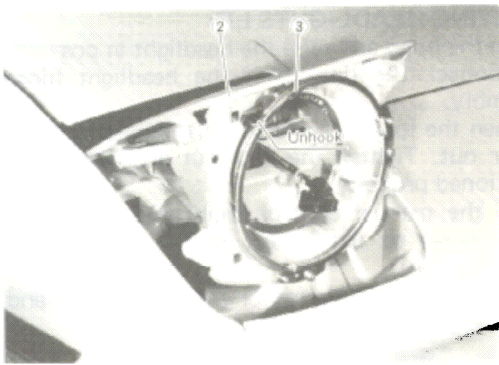

47U14X-050

REPLACING RETRACTOR HINGE

1. Remove the headlight, referring to the Page 14–16.
2. Remove the headlight lid.
3. Unhook the spring from the headlight mounting ring and take out the mounting ring.

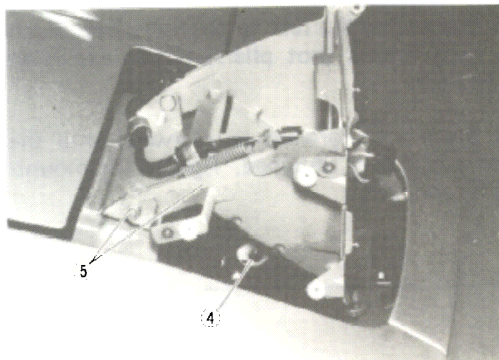

47U14X-051

4. Disconnect the link from the hinge assembly.
5. Remove the hinge mounting nut and take out the hinge assembly.
6. Install the hinge assembly in the reverse order of removing.

Cautions

- a) When connecting the link to the ball pivot, pinch them with fingers (not pliers) until there is an audible click.
- b) Whenever the retractor hinge assembly is replaced, make the up-down adjustment of the headlight lid, referring to Page 14–19.

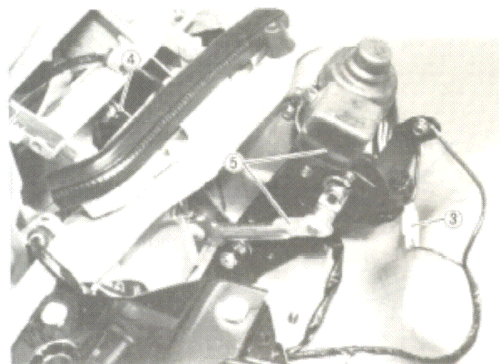

47U14X-052

REPLACING RETRACTOR MOTORS AND LINKAGE ASSEMBLY

1. Open the hood and raise the headlight in position.
2. Remove the headlight bezel.
3. Disconnect the electrical connector.
4. Disconnect the link from headlight hinge assembly.
5. Remove the retractor motor and linkage assembly.

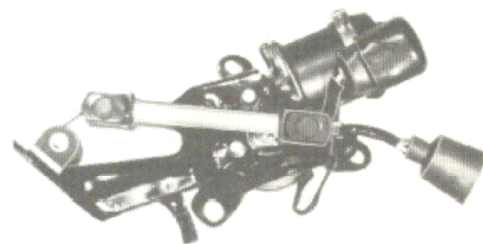

47U14X 053

5. If necessary, disassemble the retractor motor and linkage assembly.
6. Install the retractor motor and linkage assembly in the reverse order of removing.

Caution

Whenever the retractor motor and linkage assembly is replaced, make the up-down adjustment of the headlight, referring to the Page 14–18.

14 RETRACTABLE HEADLIGHTS

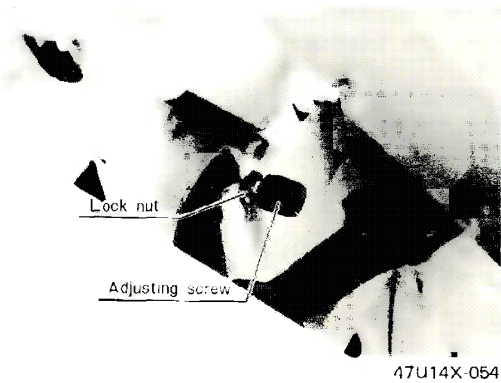

ADJUSTING HEADLIGHTS LID

1. Open the hood and raise the headlight in position.
2. Disconnect the link from the headlight hinge assembly.
3. Loosen the lock nut and turn the adjusting screw in or out. Tighten the lock nut after the lid is positioned properly.
4. Turn the manual control knob until the motor link comes to the lowest position (automatic stop position).
5. Loosen the retractor motor mounting bolts and nuts.
6. Connect the link to the hinge assembly.

Caution

When connecting the link to the ball pivot, pinch them with fingers (not pliers) until there is an audible click.

7. Move the motor forward or rearward until the desired position is obtained. Tighten the mounting bolts and nuts.

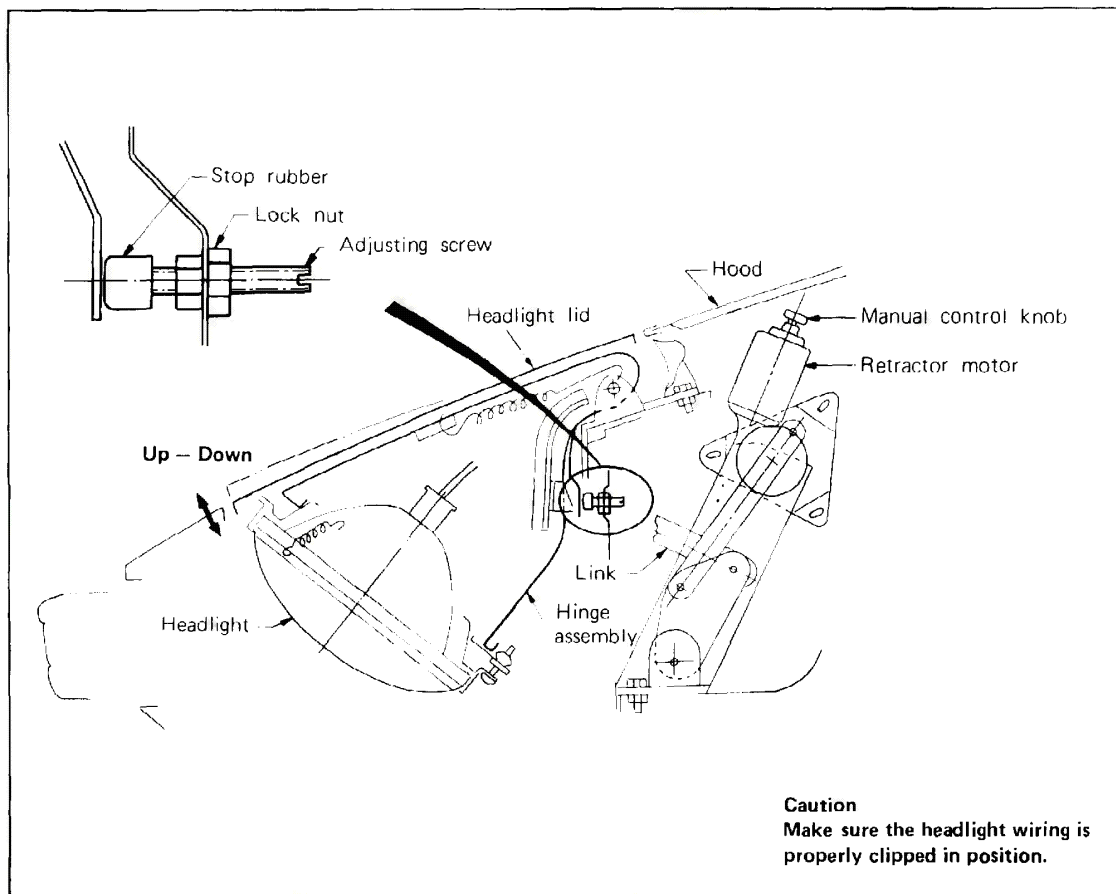

WINDSHIELD WIPER MOTOR

REMOVING WIPER MOTOR

1. With the wiper motor operating, disconnect the battery negative cable so that the wiper blades stop in the upper position.
2. Remove the wiper arms.
3. Remove the seal caps and then remove the nuts on the wiper linkage shaft.
4. Remove the cup washers and outer bushes.

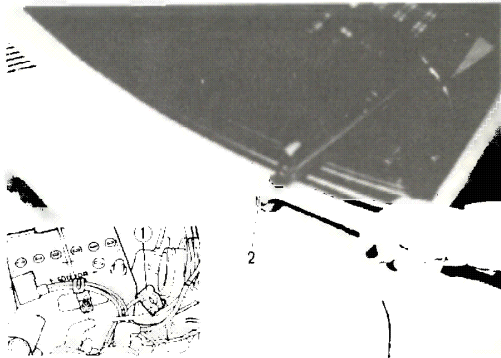

47U14X-055

5. Remove the cowl plate attaching screws and disconnect the washer hose at the washer nozzle.
6. Take out the cowl plate.

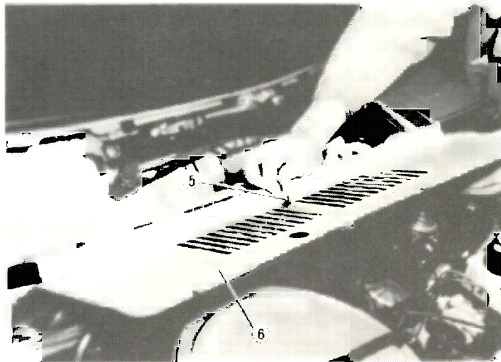

47U14X-056

7. Disconnect the wiring connectors at the wiper motor.
8. Remove the wiper motor and link assembly.

INSTALLING WIPER MOTOR

Follow the removal procedures in the reverse order.

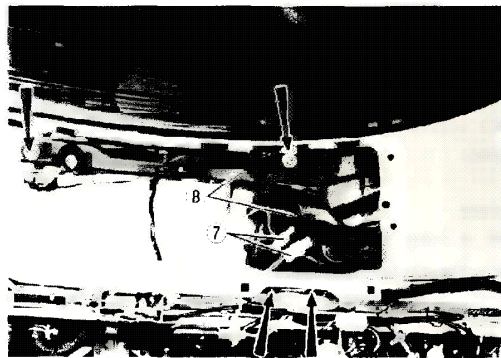

47U14X-057

14 WINDSHIELD GLASS

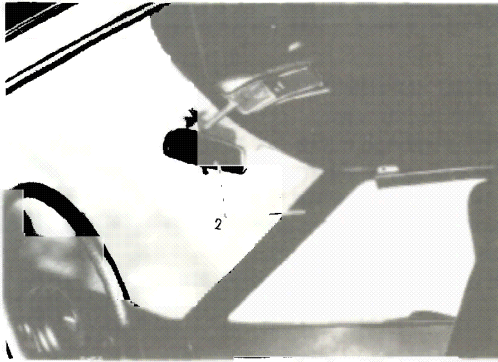

47U14X-058

WINDSHIELD GLASS

REMOVING WINDSHIELD GLASS

To replace the windshield glass, use the **window service tool set** (49 0305 870A).

1. Remove the wiper arms.
2. Remove the interior mirror and front pillar trims.
3. Remove the garnishes.

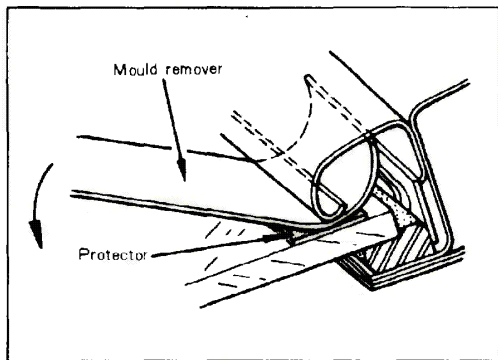

47U14X-059

4. Insert a suitable protector and remove the mould using the mould remover as shown in figure.

Caution

Before removing the mould, apply adhesive tape to protect the body from damage.

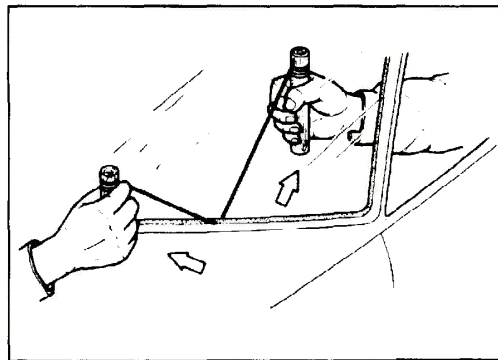

47U14X-060

5. Drill a small hole through the sealant.
6. Pass a piano wire through the hole.
7. Wind each end of the wire around a bar.
8. Pull the wire to and fro, and saw through the sealant round the edge of the glass. Then remove the glass.

Cautions

- a) Use a long sawing action to spread the work over the whole length of wire lest it break.
- b) Take care the wire does not rub on the car paint.

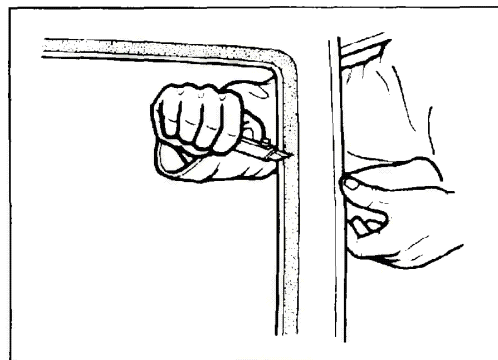

47U14X-061

INSTALLING WINDSHIELD GLASS

1. With a sharp knife cut away the old sealant, so that **1 to 2 mm (0.04 to 0.08 in)** thickness of sealant remains around the circumference of the frame. If all the sealant has come off in place, apply some primer after degreasing, and allow it 30 minutes to dry. Then put on sealant **to build up to a 2 mm (0.08 in) layer.**

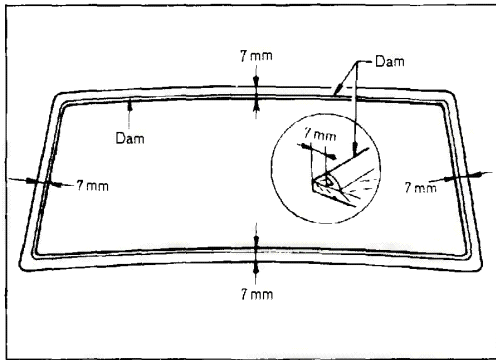

47U14X-062

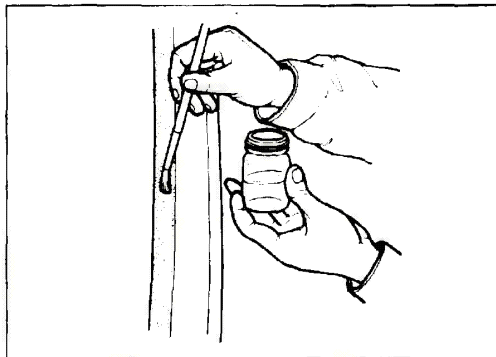

47U14X-063

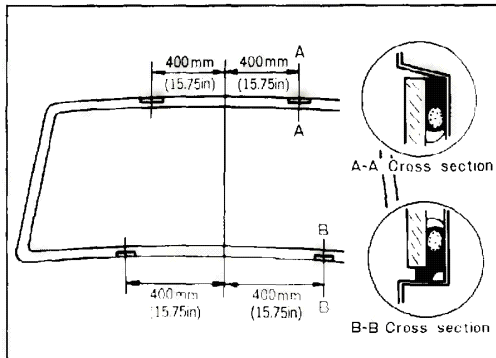

47U14X-064

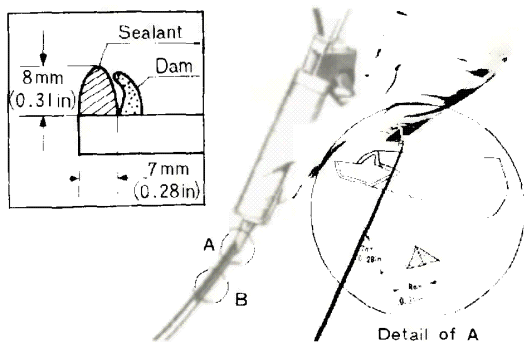

47U14X-065

2. Bond the new dam to the glass with a bonding agent. It should be positioned with its outer edge **7 mm (0.3 in)** from the glass edge, and the lip outermost.

Caution

Securely bond the dam so that it is straight and will not come apart.

3. Apply a thin coat of primer to the bonding area of the body and glass, and **allow 30 minutes** for it to dry. Keep it clear of dust. Do not touch the surface. If any gets on the hands, wipe it off quickly.

4. Bond the spacers to the body as shown in figure.

Caution

Use the proper spacer for both the upper and body.

5. Insert the moulding clips on their points. If any found defective, replace the clip with new one.

6. Prepare the nozzle of the sealant gun so that it has a flange which can run along the edge of the glass, and a "V" out of which the sealant can flow. Apply the sealant, once the primer is dry, around the whole circumference to fill the gap between the dam and the edge of the glass, with a ridge of sealant **8 mm (0.3 in)** high. Keep the run of the sealant smooth and even, re-shaping it where necessary with a spatula.

7. Lift the glass into place. Push the glass lightly in towards the car to squeeze the sealant.

Caution

Open the window, so the glass will not be pushed out by air pressure when a door is closed.

14 SIDE WINDOW GLASS

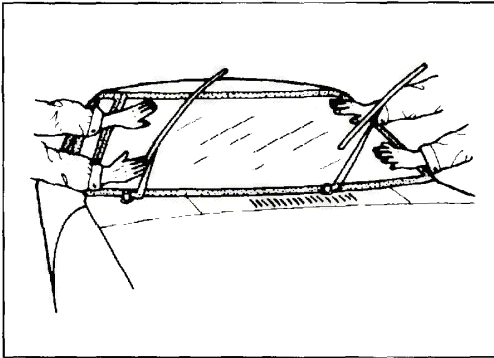

47U14X-066

8. Smooth away any sealant that oozes out with a spatula. If there are any points of poor contact add more sealant.
9. Leave the sealant time to harden without disturbing the glass.
This will take **5 hours at 20°C (68°F)** and **24 hours at 5°C (41°F)**.
10. Recheck for any points of poor sealing that might allow a leak, and rectify.
11. Clip in the mould. Refit the interior mirror, pillar trims and garnishes.

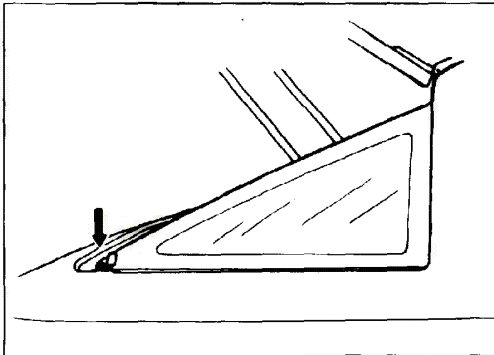

47U14X-067

SIDE WINDOW GLASS

REMOVING SIDE WINDOW GLASS

1. Remove the garnish and remove the glass plate attaching screw.

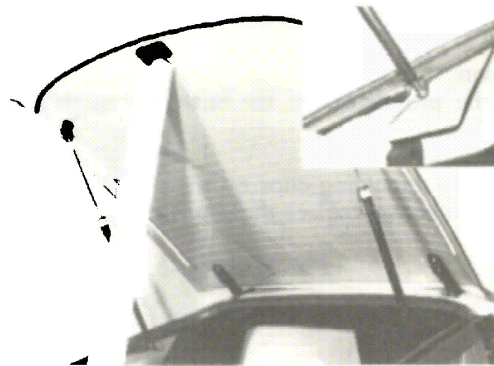

47U14X-068

2. Open the rear glass hatch and disconnect the electrical connector from the rear pillar.
3. Remove the rear pillar trims, and remove the glass attaching nut.
4. Disconnect the damper stay end from rear pillar and hold the rear glass hatch.
5. Remove the side glass referring to the Step 5 to 8 on Page 14–20.

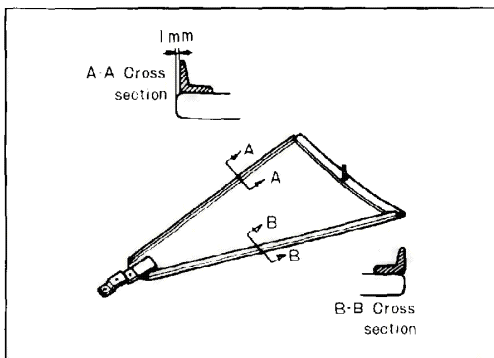

47U14X-069

INSTALLING SIDE WINDOW GLASS

Install the side window glass referring to the Step 1 to 10 on Page 14–20 **noting** the following points.

1. Bond the new dam to the glass with a bonding agent. It should be positioned as shown in figure.

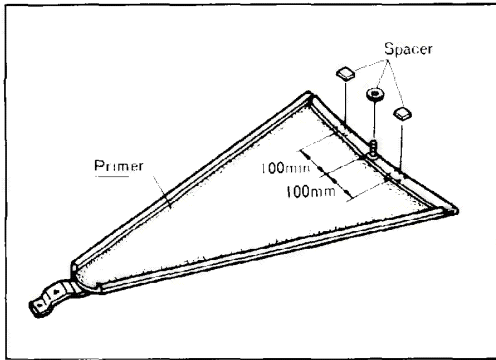

47U14X-070

2. Apply a thin coat of primer to the bonding area of the body and glass as shown in the figure.
3. Bond the spacers to the glass as shown in the figure.

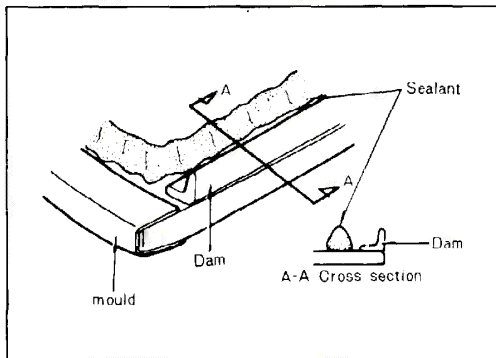

47U14X-071

4. Apply the sealant around the whole circumference of the glass as shown in the figure.

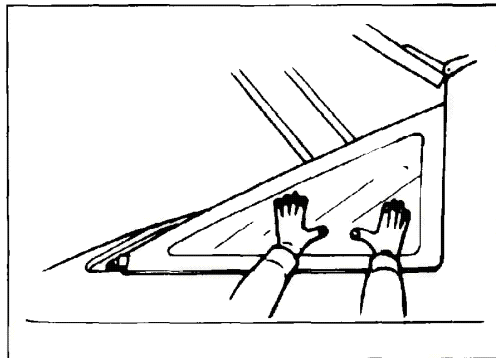

47U14X-072

5. Install the glass attaching nut.
6. Install the center pillar trim and rear side pillar trim.
7. Install the damper stay end to the body.
8. Install the glass plate attaching screw.
9. Install the garnish.

BODY CHECKING DIMENSIONS

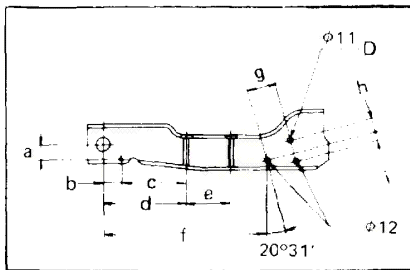
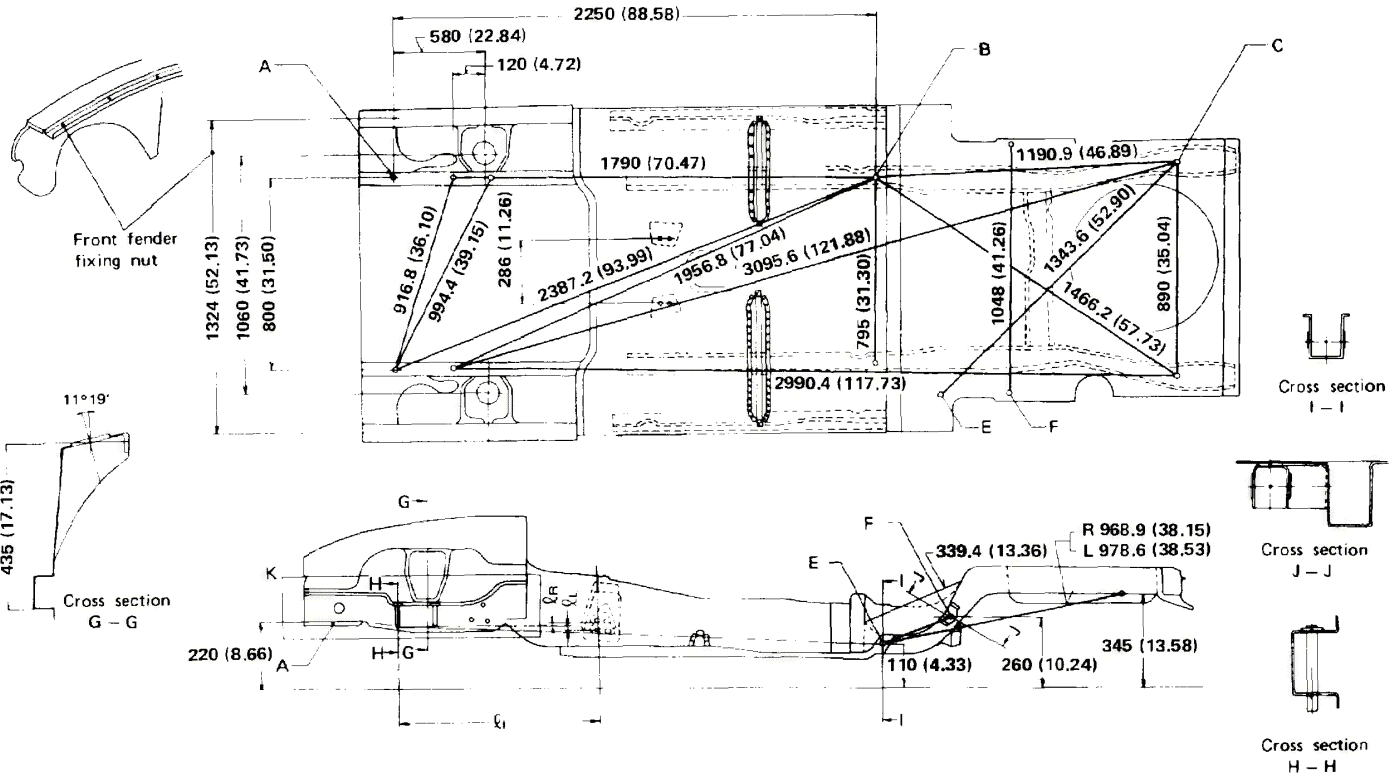

4/014X4/73

Detail of portion <

- a : 45 (1.77)
 - b : 107 (4.21)
 - c : 283 (11.14)
 - c : 390 (15.36)
 - e : 140 (5.51)
 - f : 680 (26.77)
 - g : 82 (3.23)
 - h : 52 (2.05)
 - h : 33 (1.30)
- A. Front frame basic hole
 - B. Rear frame basic hole
 - C. Rear frame basic hole
 - D. Steering gear box fixing hole
 - E. Lower arm fixing hole
 - F. Upper arm fixing hole

Transmission		ℓ_1	ℓ_R, ℓ_L
Automatic	Right	897 (35.32)	$\ell_R = 26.85 (1.06)$
	Left	910 (35.83)	$\ell_L = 32.5 (1.28)$
Manual	Right	932 (36.69)	$\ell_R = 24 (0.95)$
	Left	945 (37.21)	$\ell_L = 35 (1.38)$

Caution

All dimensions are shown in mm. (the parenthesized figures are shown in inch.)